

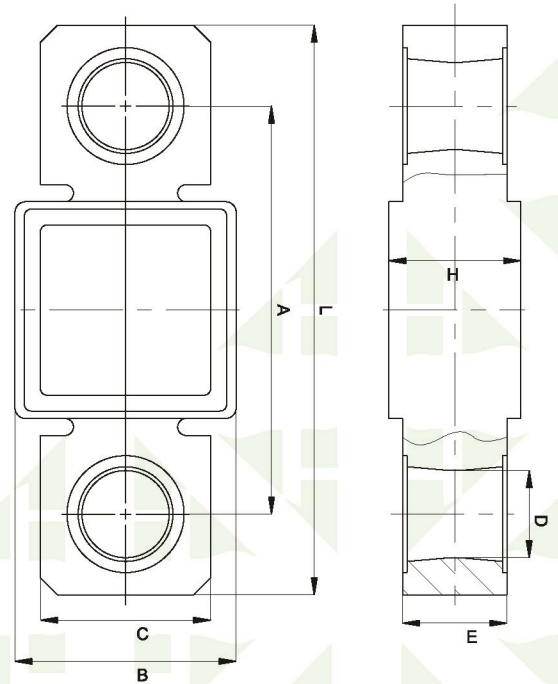

# Load Meter

## CLY Series

Unit:mm



### Technical Parameter

- Accuracy 0.1%F.S.
- Time to Stable Reading  $\leq 8s$
- Maximum Safe Load 125%F.S.
- Limited Overload 400%F.S.
- Overload Alarm 100%F.S.+9e
- Surrounding  $-20^{\circ}C \sim 60^{\circ}C$
- Operating Temperature  $-10^{\circ}C \sim 40^{\circ}C$

### Features

- Sturdy design dynamometer to weigh the force of gravity or the pulling force
- Superior alloy steel, preferable to dynamometers with larger capacity
- In weighing the pulling force, the dynamometer has the functions of peak
- In weighing the force of gravity, the dynamometer support kg/lb conversion
- 6 digit 18mm FSTN LCD display with LED backlighting

Max Capacity	Division	Weight(kg)	L	B	C	H	E	A	D
0.5t	0.2kg	1.6	204	99	46	50	30	158	Φ26
1t	0.5kg	2.0	204	99	46	50	30	158	Φ26
2t	1kg	2.1	204	99	46	50	30	158	Φ26
3t	1kg	2.3	204	99	46	54	30	158	Φ26
5t	2kg	3.6	222	99	60	58	35	162	Φ31
10t	5kg	6.2	268	104	80	62	49	192	Φ41
15t	5kg	9.5	304	110	92	66	58	212	Φ46.5
20t	10kg	15.0	344	120	120	66	66	232	Φ56.5
30t	10kg	21.9	394	132	132	73	73	264	Φ66
50t	20kg	45.5	500	150	150	100	100	340	Φ80